

# 27±AC AT GREENWAY FARMS

FORT MCCOY, NE MARION CO., FLORIDA



- Property has a mixture of improved pasture, beautiful oak hammocks & a serene grass pond
- ADJACENT TO THE CROSS-FLORIDA GREENWAY
- TONS OF WILDLIFE - deer, turkey, ducks, and all sorts of other native animals
- 5 minutes from Ocklawaha River, 10 minutes from Ocala National Forest, 30 minutes to St. Johns River
- Zoning: A1 / Land Use: Rural Lands - minimal taxes with agriculture exemptions (approx. \$1.56/acre)
- Minor Deed Restrictions to protect property values... NO HOA (mobiles & animals welcome).

## \$487,025

Data contained herein is for informational purposes only. Buyer must perform their own inspections on the land being offered for sale in this brochure.

 **McBRIDE**  
**LAND & DEVELOPMENT CO.**  
Licensed Real Estate Broker

Phone: (352) 401-3755

Mobile: (352) 459-5283

[www.mcbrideland.com](http://www.mcbrideland.com)





7/9/2024

1:4,514

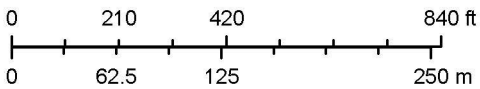

Marion County Property Appraiser  
Marion County, FL

**DISCLAIMER:** This is a work in progress. This application was compiled by the Marion County Property Appraiser's Office solely for the governmental purpose of property assessment. These are NOT surveys. Our goal is to provide the most accurate data available, however, no warranties, expressed or implied are provided with this data, its use, or interpretation. All information subject to change without notice. Use at your own risk.



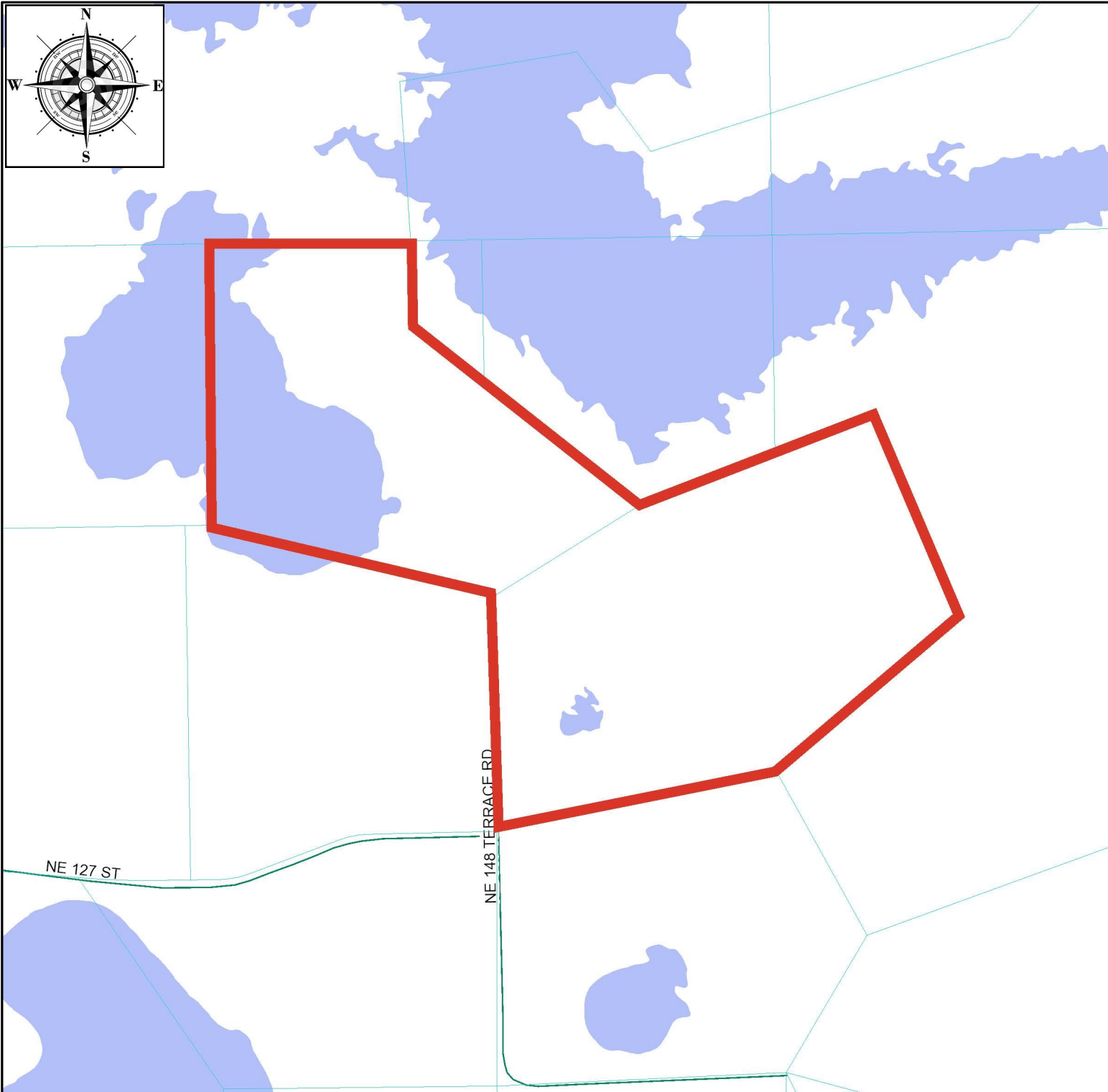
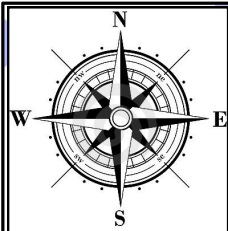

7/9/2024

1:4,514

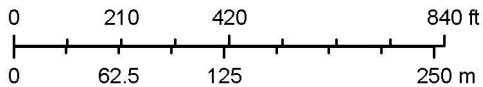

Marion County Property Appraiser  
Marion County, FL

**DISCLAIMER:** This is a work in progress. This application was compiled by the Marion County Property Appraiser's Office solely for the governmental purpose of property assessment. These are NOT surveys. Our goal is to provide the most accurate data available, however, no warranties, expressed or implied are provided with this data, its use, or interpretation. All information subject to change without notice. Use at your own risk.

# DIRECTIONS

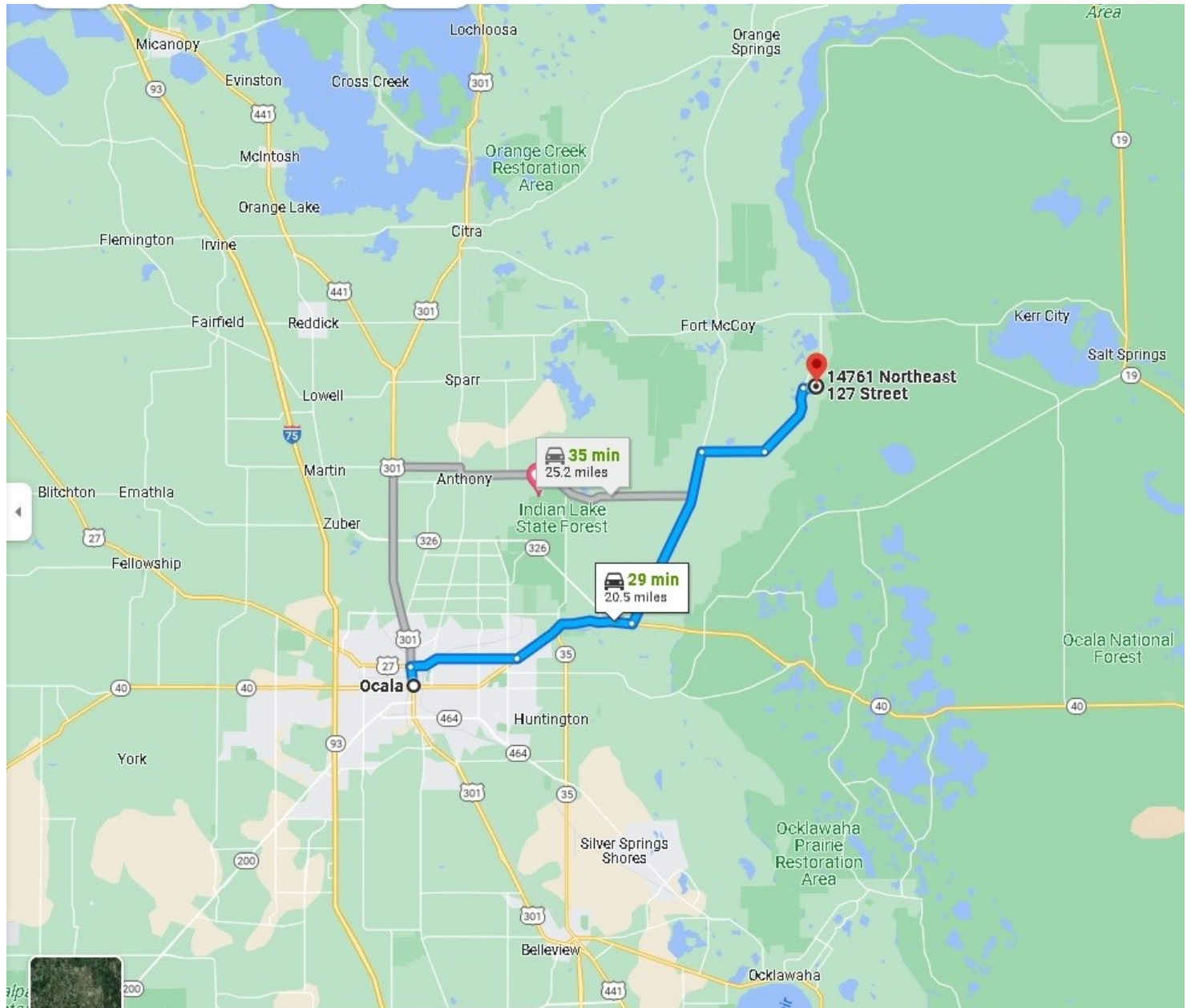

## **FROM OCALA:**

- East on Silver Springs Boulevard (SR 40) to Hwy 315;
- North on Hwy 315 for 6.5 miles to NE 105 Street;
- Right on NE 105 Street for 2.1 miles then veer Left onto NE 150th Ave Rd;
- Take NE 150th Ave Rd for 2.7 miles to Greenway Farms entrance on Right.
- Continue thru gate on limerock road for half mile and turn left, property will be on right.

**SHOWN BY APPOINTMENT ONLY**